



A Story About Connection

The West Hollywood Aquatic and Recreation Center is a study in challenges. Built as a replacement for an aging community gym and aquatics center in an attempt to create more contiguous park space, the ARC reaches beyond the boundaries of the park, spanning across a public street, resting in a parking lot 35 feet below the finished grade of the park. The site is bounded by an existing library and parking structure and a few small businesses and restaurants. Public tennis courts sit on top of the library parking structure. The goal of the project was to bridge the rooftop tennis courts to the ARC, create a main entry to the ARC at the park level and land the bulk of the facility in the parking lot 35 feet below the park.

Narrative

Built as a replacement for an aging community gym and aquatics center to create more contiguous park space, the stacked ARC reaches beyond the boundaries of the park, spanning across a public street, resting in a parking lot 35 feet below the finished grade of the park. The goal of the project was to create a bridge to the adjacent rooftop tennis courts, create a main entry to the ARC at the park level and land the bulk of the facility 35 below.

The project has achieved LEED Gold Certification and is tracking petal certification thru the Living Building challenge. The energy efficient envelope and systems beat Title 24 by 25%, and power is supplemented by a 65kW rooftop photovoltaic array. The constraints of the site caused the building to have a minimal footprint and there is mitigation of 100% of the stormwater runoff on site.

Passive heating and cooling are achieved through natural ventilation, thermal mass, and large format fans. Natural daylight fills the public spaces, and a stacked, automated parking system minimizes the impact of cars on the site. The project gives back open space to the community while providing an effective mix of recreation, education, and meeting spaces.

The project was the final phase of the completion of a masterplan for the park and community buildings. The project creates a state-of-the-art community recreation and aquatic facility while taking the bulk of the square footage out of the park creating more contiguous open park space in an extremely dense community. The city of West Hollywood is one of extremes. A robust senior population, a vibrant Russian immigrant population, movie stars and entertainers, athletes and one of the largest LGBTQ communities in the State. Creating a solution that brought this diverse population together involved intense community and business leader interaction throughout the design process.

Since its very recent completion, the park and building have hosted a new summer day camp program, a local LGBTQ pride celebration, artist receptions and multiple dodge and pickle ball competitions. The project was designed to embrace the diversity of the community and enable them to connect in new and varied ways. To that end, after only a few months of operation, the project is a success.

This project is meant to solicit discovery and delight. It is a respite from the world and a place for joy, special occasions, events and learning. It is only through input and self-awareness that this meaning will be maintained. With the central purpose of serving the public, it was imperative that the public's voice be heard.

It was also imperative that each voice together enacted change. The large community meetings and presentations became opportunities for compromise and acceptance. The result is a building that appeals to everyone and not just a select few.



Design for Equitable Communities

West Hollywood is an extremely dense community of very diverse individuals and families. The ARC sits within the West Hollywood Park in the center of the community. The park has always been the center of life for Weho and is bounded by businesses, residences, shops and restaurants. The majority of the users walk to the park as well as the ARC although the facility is attracting use by communities as much as 20 miles away. The design is well connected to the park and the community thru landscape, walking paths and public art..

West Hollywood Aquatics & Recreation Center



Aerial View



SITE PLAN

West Hollywood Aquatics & Recreation Center



- 1 STACKED: PARKING / SPORTS COURTS / CHANGING ROOMS & EQUIPMENT / POOL DECK
- 2 BRIDGE BUILDING OVER EXISTING ROAD
- 3 STACKED: COMMUNITY SPACE / DAY CARE / STAFF OFFICES / ROOF DECK / ROOF GARDEN
- 4 EXISTING ROADWAY BELOW (EL TOVAR)

- 5 GRAND STAIR CONNECTION TO THE GREAT LAWN
- 6 GREAT LAWN
- 7 NATIONAL AIDS MEMORIAL
- 8 PUBLIC ART
- 9 SPORTS COURTS
- 10 DOG PARK

PROGRAM & CIRCULATION DIAGRAM

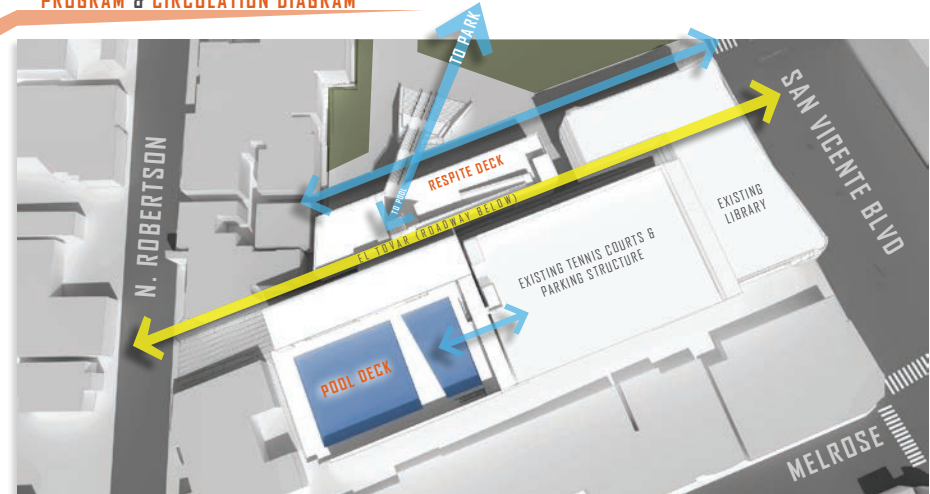

Design For Integration

VEHICULAR PEDESTRIAN

This design is meant to bridge the challenges of the budget and the constraints of the site with a strong sustainable design narrative, a connection to the community and the spectacular views and weather. Symbolically, the building represents the broader concept of connection through the integration of a figural "grand stair" which connects all levels of the facility directly to the park. The stair is also the center of gathering and community events while also creating a striking central focus to the design.

As an aquatics and recreation center, the facility is designed to support health and wellness. Through smart, sustainable design strategies the building itself also supports this mission.

Design For Change

The ARC is designed to exist well into the future by creating spaces that are flexible and adaptable but also appeal to a wide variety of uses and users. Spaces have the ability to break down or expand or conjoin with public space to extend their usability. The multi-purpose sports courts are designed to accommodate a wide variety of sports uses as well as social functions. The common areas are designed as social spaces as well as civic and cultural event spaces which can expand into the more specialized areas.



Community Respite Deck



Design For Discovery

The ARC story is one that has already been shared throughout the 8 years of planning and construction of the facility. The design and design process has been presented to community groups, school groups and industry organizations.

From the start of the project, the community has been an integral contributor to the design process. A large and very involved community design review was formed and met regularly to ensure that all members of the community were heard. The group was made up of a wide variety of community users from athletes and seniors to the mobility challenged and even children.



View of Grand Stair



View Deck

Design For Well Being

The West Hollywood ARC is a light filled, naturally ventilated, all access connection to the community. the City has a very robust population made up of extremely active citizens ranging from toddlers to seniors.

A universal access approach to both the park as well as the building ensures not only equal access but an equal experience.

As part of the design committee, members ranged from a seniors and children to the physically disabled. ideas were discussed and tested constantly throughout the design process. The building common and staff areas exploit the dramatic views into the park and most are naturally ventilated. The design features many social and respite spaces of varied form and scale.



View of Recreational Pool

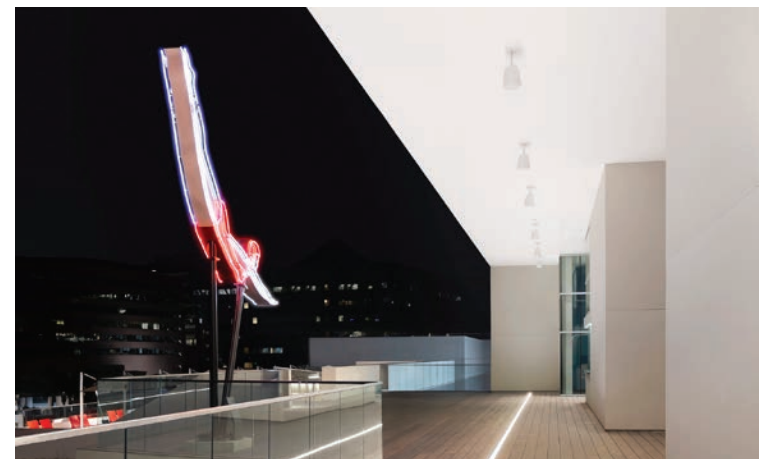

The Diver



8



9



10

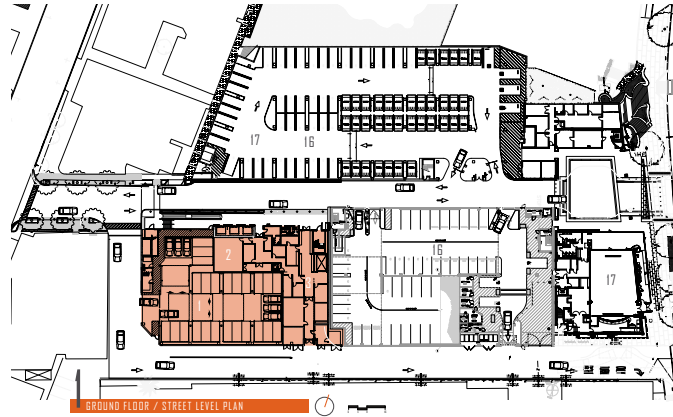

GROUND FLOOR / STREET LEVEL PLAN

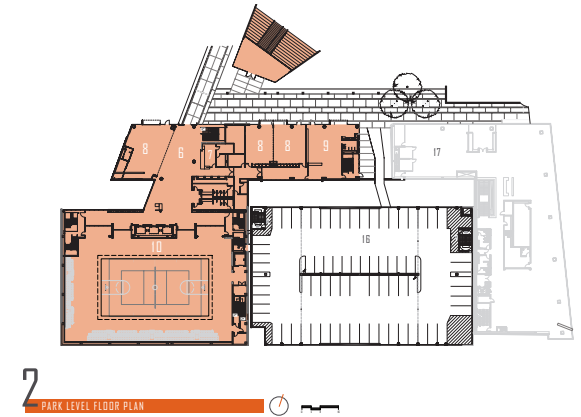

2 PARK LEVEL FLOOR PLAN

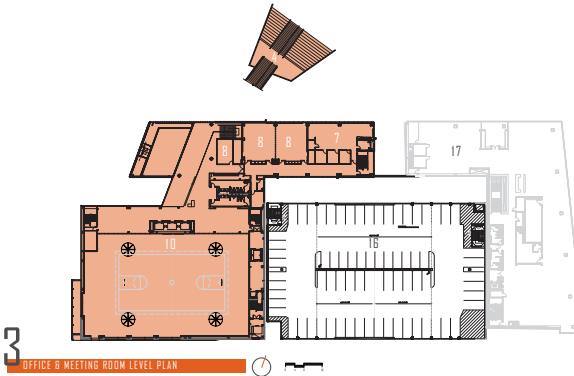

3 OFFICE & MEETING ROOM LEVEL PLAN

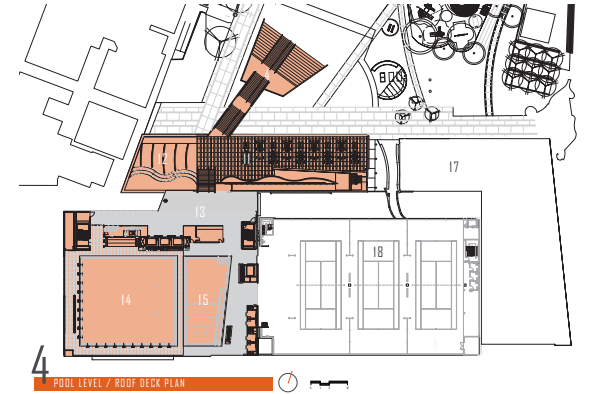

4 POOL LEVEL / ROOF DECK PLAN

- 1 PARKING GARAGE
- 2 CABLE TELEVISION RECORDING STUDIO
- 3 FACILITIES MAINTENANCE
- 4 GRAND STAIR
- 5 CAFE
- 6 LOBBY
- 7 STAFF
- 8 COMMUNITY MEETING ROOM
- 9 TINY TOTS
- 10 GYM
- 11 RESPITE DECK
- 12 VEGETATED ROOF
- 13 YOGA DECK
- 14 COMPETITION POOL
- 15 RECREATION POOL
- 16 EXISTING PARKING STRUCTURE
- 17 EXISTING LIBRARY
- 18 EXISTING TENNIS COURTS

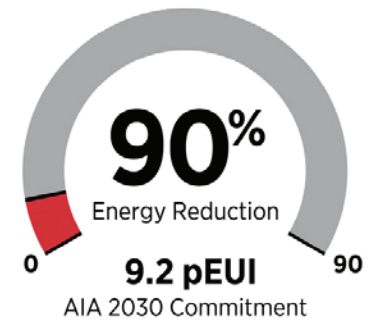

STRATEGIES

- Project tracking LEED Gold certification
- Energy Efficient Envelope and Systems beat Title-24 by 25%
- Environmentally Sensitive Materials and Products
- Minimum Building Footprint
- Mitigation of 100% of stormwater runoff on site

- 1 On Site Energy Production through the use of an Integrated Photovoltaic Canopy
- 2 Passive Heating and Cooling through Natural Ventilation, Thermal Mass, and Large Format Fans
- 3 Displaced Ventilation in Large Volume Spaces
- 4 Re-use of Grey Water from Locker Room Showers for Irrigation
- 5 Vegetated Roof and Grow Walls
- 6 Natural Daylight in Public Spaces
- 7 Efficient LED Lighting in the Park and in the Building
- 8 Stacked Automated Parking System
- 9 Underground Cisterns to collect stormwater for Park Irrigation

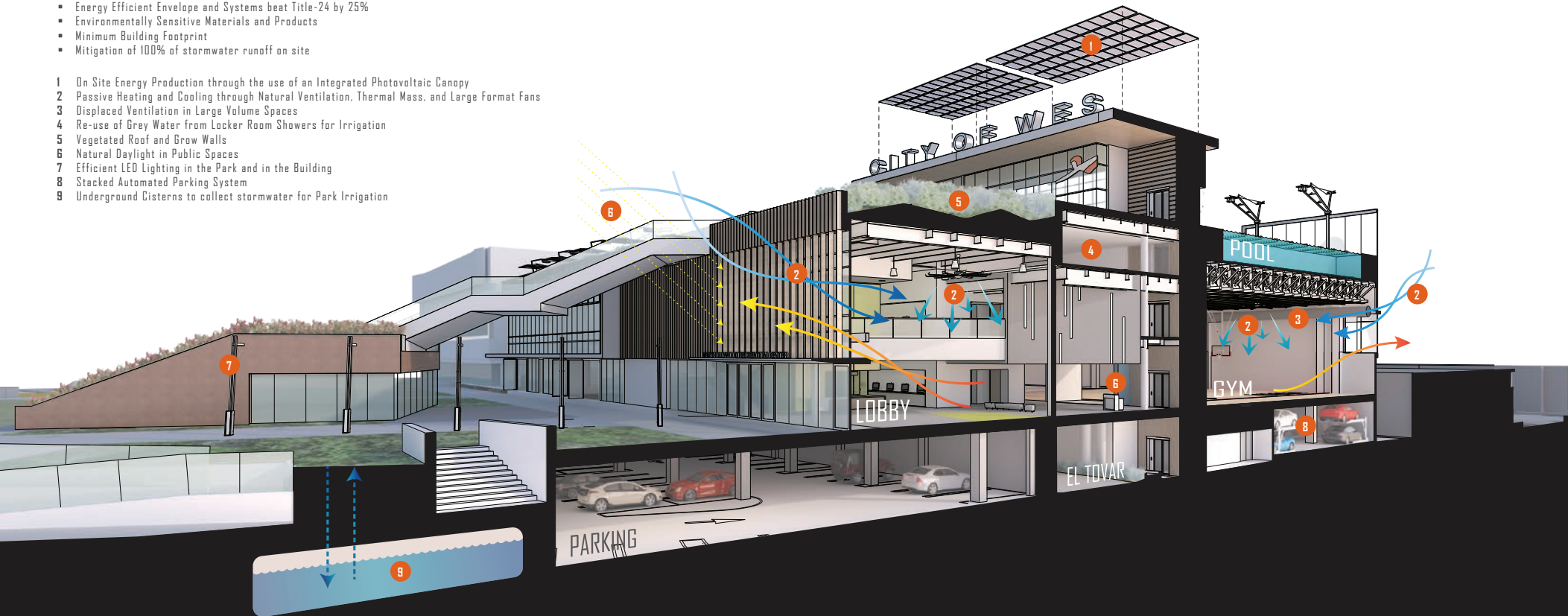

Design for Energy

As the most recent public project in the City of West Hollywood, the ARC is also the most aggressive sustainable project built within the community. While the building integrates both active and passive strategies, the main objective was to provide cost and energy savings and maximize the health and well being of the community.

The building was designed to integrate natural ventilation in the majority of public spaces incorporating large bi-fold doors which open directly to the park. In addition to air flow, natural daylight and views to the park are prevalent in 90% of the interior spaces. The interior environment is also tempered by thermal mass walls and large format fans.



View of Lobby Entry

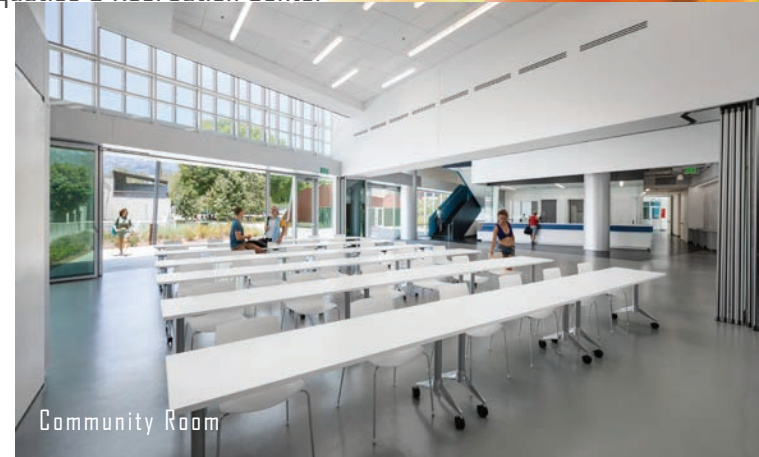

Community Room



Path to Tiny Tots



View of Bridge Building



View of Lobby

Design For Ecosystems

The stacked building design implements a minimal footprint to create as much open park space for the residents as possible. While turf was required for park function, all other landscape areas adhere to the sustainable narrative. A lift parking structure was incorporated which parks twice as many cars in the same amount of space previously supplied by a surface parking lot.



View of Multi-Sports Court

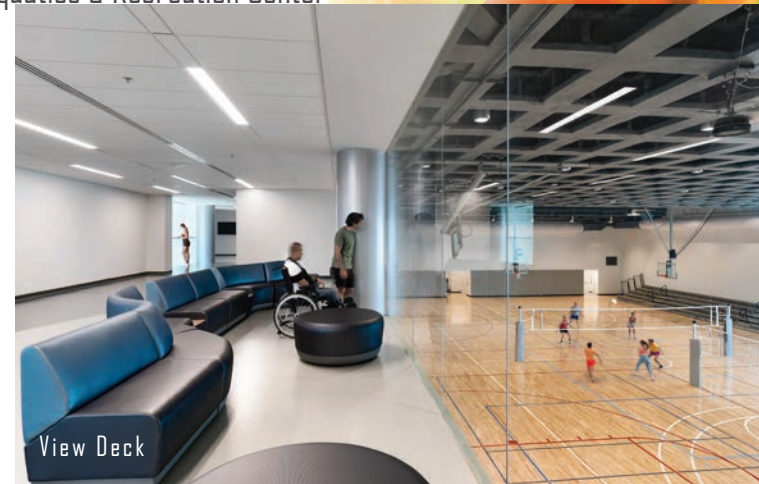

View Deck



View From Melrose

Design For Resources

The previous community structures existed on the park site for almost 60 years. Looking into the future, it is in the best interest of our world to build structures that last. That happens through an adequate needs analysis, and smart design that it is maintainable, durable, timeless and environmentally responsible.



View From Park